

DISNEY'S BOARDWALK RESORT

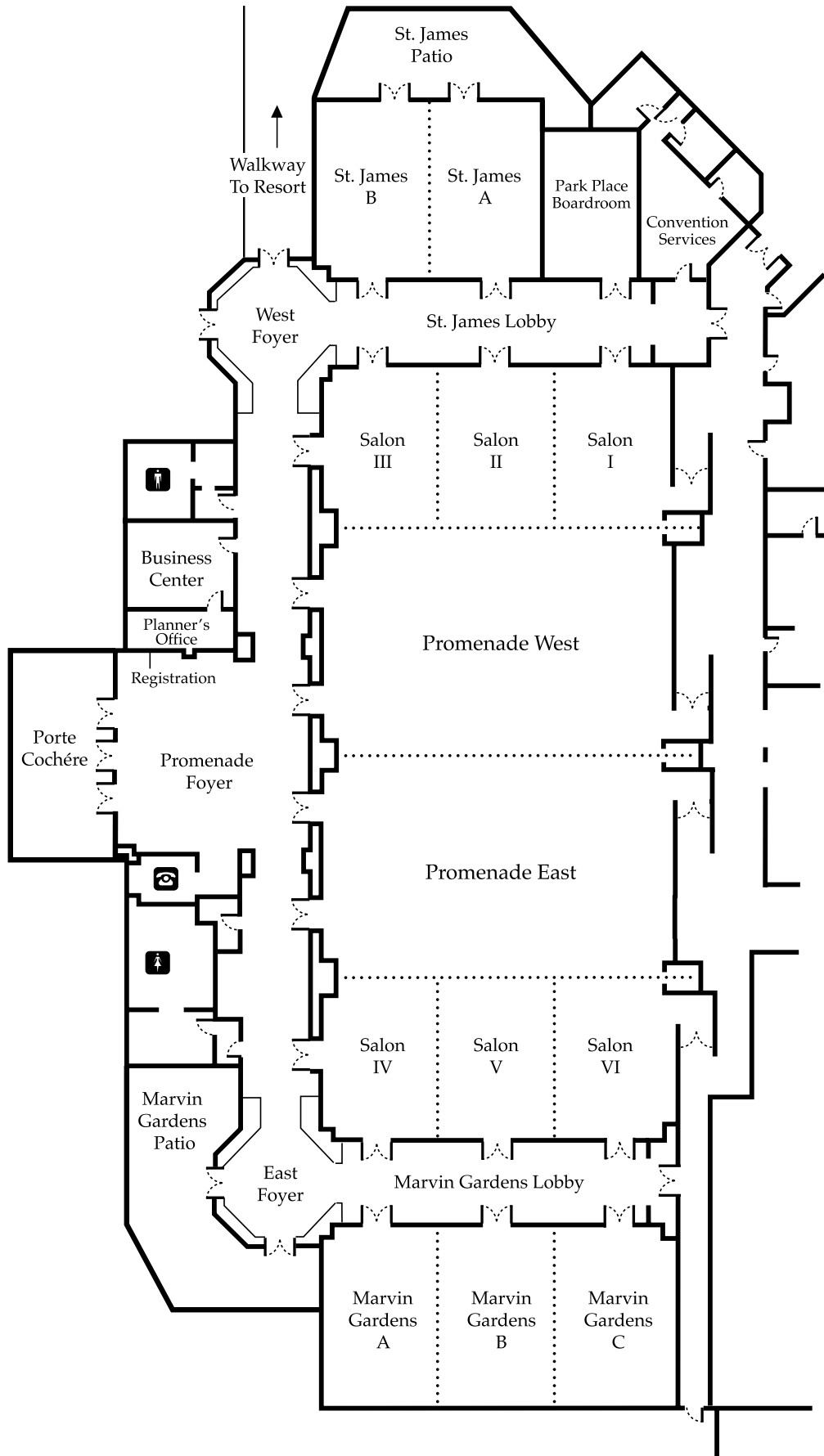

DISNEY'S BOARDWALK RESORT

Room Name	Square Feet	Width	Length	Ceiling Height	Theater	School Room	Conference	U-shape	Banquet Rounds	Reception
Promenade Ballroom	10,132	149	68	22	1,040	477	•	•	660	916
Promenade East & West	5,916	87	68	22	584	321	•	•	400	520
Promenade West	2,924	43	68	22	280	165	58	63	200	260
Promenade West w/Salons I-III	5,032	74	68	22	458	282	58	76	330	458
Promenade East	2,924	43	68	22	280	165	58	63	200	260
Promenade East w/Salons IV-VI	5,032	74	68	22	458	282	58	76	330	458
Promenade Salons I-VI (each)	682	22	31	19	50	30	20	24	40	40
Park Place Boardroom	522	18	29	14	•	•	14	•	•	•
Marvin Gardens	2,312	68	34	14	170	108	58	60	130	150
Marvin Gardens A-C (each)	748	22	34	14	50	30	20	24	40	40
St. James	1,462	43	34	14	110	69	40	38	90	100
St. James A-B (each)	748	22	34	14	50	30	20	24	40	40
The Attic	2,370	•	•	•	•	•	•	•	•	50
Atlantic Dance Hall*	13,000	•	•	•	•	•	•	•	120	450
Outdoor Areas										
BoardWalk Inn Gardens	8,640	•	•	•	•	•	•	•	350	400
The Croquet Lawn	4,464	48	93	•	•	•	•	•	280	350
BoardWalk Inn Poolside Green	2,252	•	•	•	•	•	•	•	180	250
Convention Center Overlook	2,512	•	•	•	•	•	•	•	•	200
Sea Breeze Point	1,110	•	•	•	•	•	•	•	100	160
Harbor Club Breezeway	616	•	•	•	•	•	•	•	•	70
Marvin Gardens Patio	950	•	•	•	•	•	•	•	50	50

* Located within walking distance of the BoardWalk Inn Resort